

What's New in WebCenter 24.03



User Interface & Experience

Complete work faster with a powerful and intuitive user interface.

- (24.03) Pin Columns for Customized Viewing
 - Pin columns to either the left or right side of your screen, ensuring the information most important to you is always within view. This feature allows for a more personalized and efficient workspace by keeping critical data fixed while you scroll through other content. Whether it's tracking key metrics or keeping essential tools accessible, pinning columns enhances your ability to multitask and stay organized.
- (24.03) Content Sheet Approval - Discussion Improvements
 - WebCenter now offers streamlined discussion management for content sheet approvals. Features include resolving discussions to concentrate on pending items, disabling comments post-approval for clarity, and presetting discussion participants for targeted communication. These updates foster a more focused and efficient approval process.

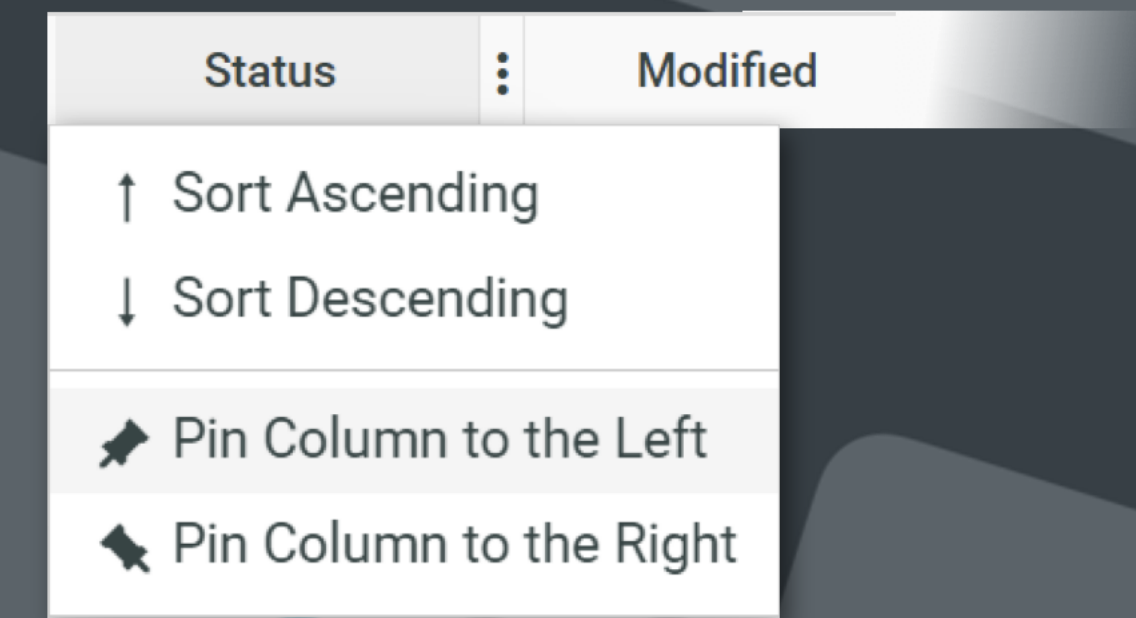

Pin Column Options

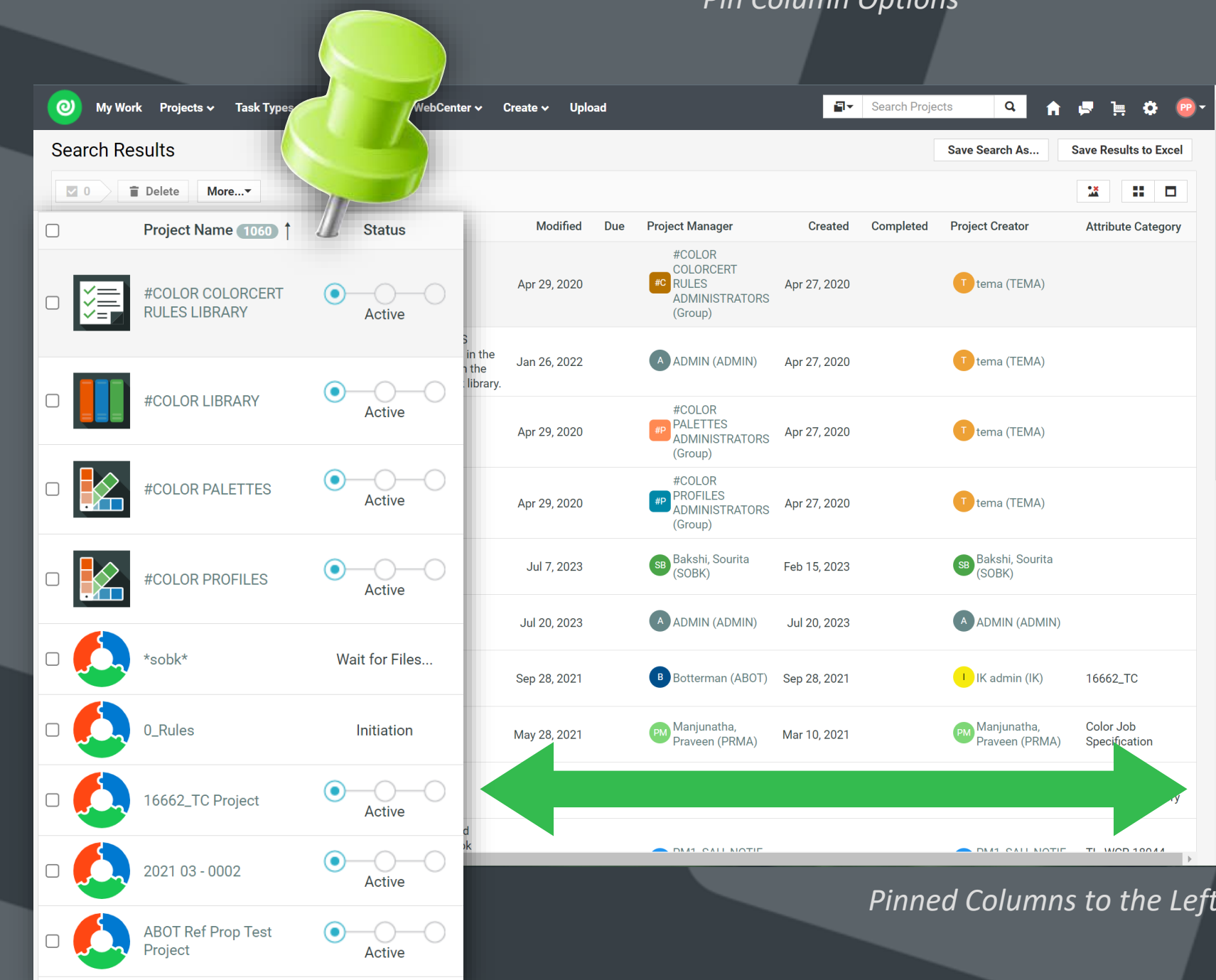

Pinned Columns to the Left



User Interface & Experience

Complete work faster with a powerful and intuitive user interface.

■ (24.03) Enhanced Notification Preferences

- Now, directly manage your alert settings with our new notification preferences. Easily opt out of notifications you don't need without admin intervention. This update provides a straightforward way to control what you see and when, making your experience more personalized and less cluttered.

■ (24.03) Dashboard Task Creation Enhancements

- Introducing new buttons in the dashboard for quicker task creation—either preconfigured for immediate action or customizable via a form. Now, you can also start tasks directly from a form, adjust task lead times for automatic due date updates, and link task due dates with project milestones for better alignment.

■ (24.03) Task Window Update: Save Without Closing

- Now, when you click "save" while working on a task, the window stays open, allowing you to continue your work uninterrupted. This update removes the need to reopen the task after saving, streamlining your workflow.

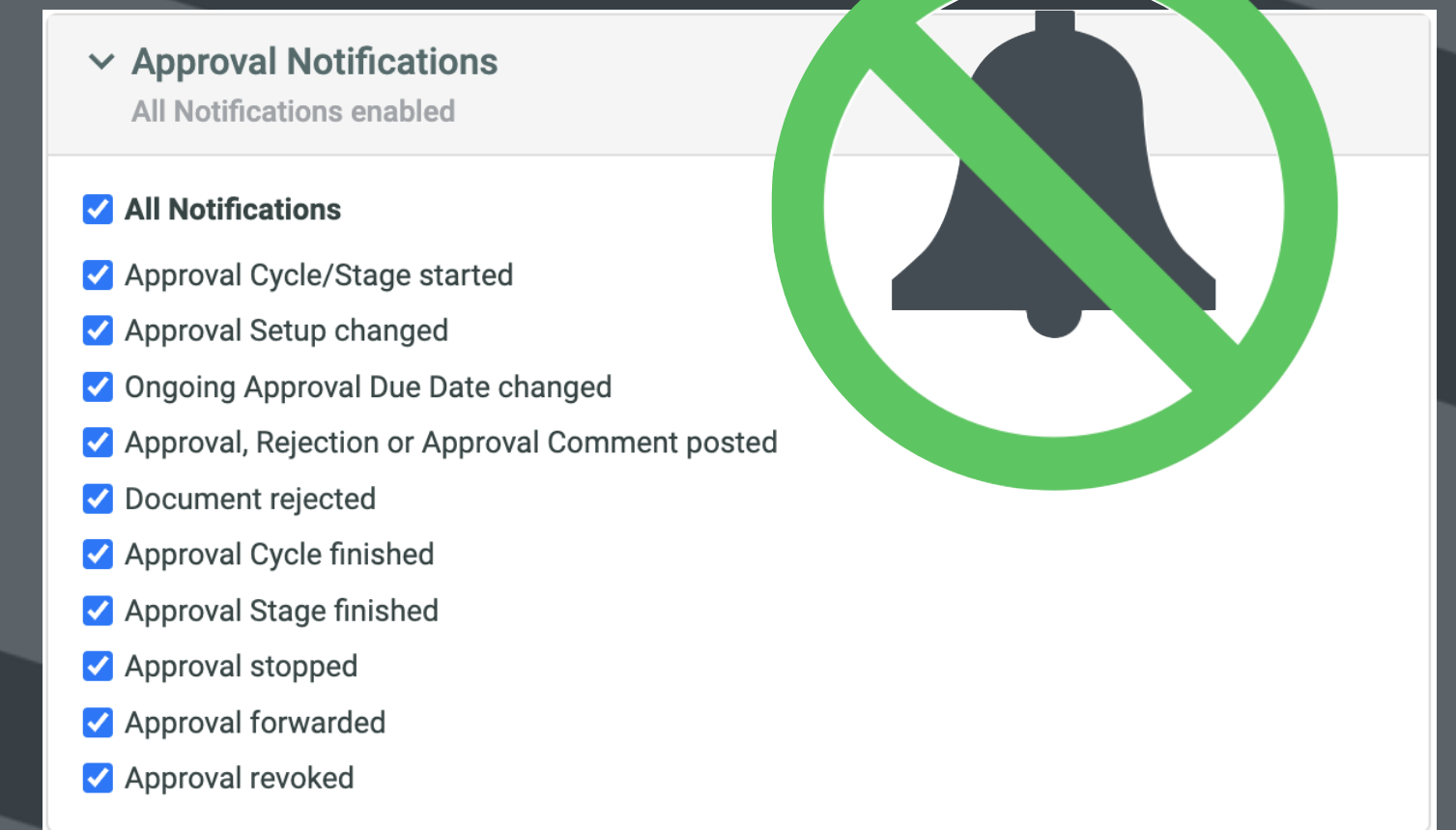

Enhanced Notification Preferences

HISTORY: (23.11) Dashboards Improvements to Protect Unsaved Work (23.11) Improved UX for Unprocessed MS Office Documents (23.11) Browser Navigation Enhancements (23.07) Copy With References (23.03) Global Styling for Buttons (23.03) Global Styling for Menu Layout in the Page Builder (23.03) New Progress Bar Visible When Saving Forms (23.03) The WebCenter Favicon is configurable via the UI (22.11) Update to Latest Version (22.11) Duplicate (22.07) Script Button Actions (Dashboards) (22.07) PCM in Dashboards (22.07) Reorder Document Rows in List View (22.07) Edit document reference properties (22.03) Script Button Actions (Documents) (22.03) Visibility Rule Enhancements (22.03) Document Reference Rendering



WebCenter SaaS

Unlock the power of Esko Cloud Services with WebCenter SaaS

- **(24.03) Convert on Download: Flexible Format Options**
 - Enhance your workflow with our new "Convert on Download" feature. Now, users can select from allowed formats for downloading assets. Administrators can configure this feature to enable users to convert and download files in preferred formats directly from the cloud. Once the conversion is complete, users will receive an email notification with a link to download the converted file, streamlining the process and ensuring you have the right format at your fingertips.
- **(24.03) Widget availability in Deep Zoom Mode**
 - Approval details and the attribute category widget are now accessible in Deep Zoom mode, facilitating the approval or rejection of artwork without interruption.
- **(24.03) Search Text in Microsoft Office Documents**
 - Text search now includes MS Office documents for SaaS WebCenters. Activating "Live Text" search for PDFs and Adobe Illustrator documents extends this capability to MS Office files, enhancing document search-ability.

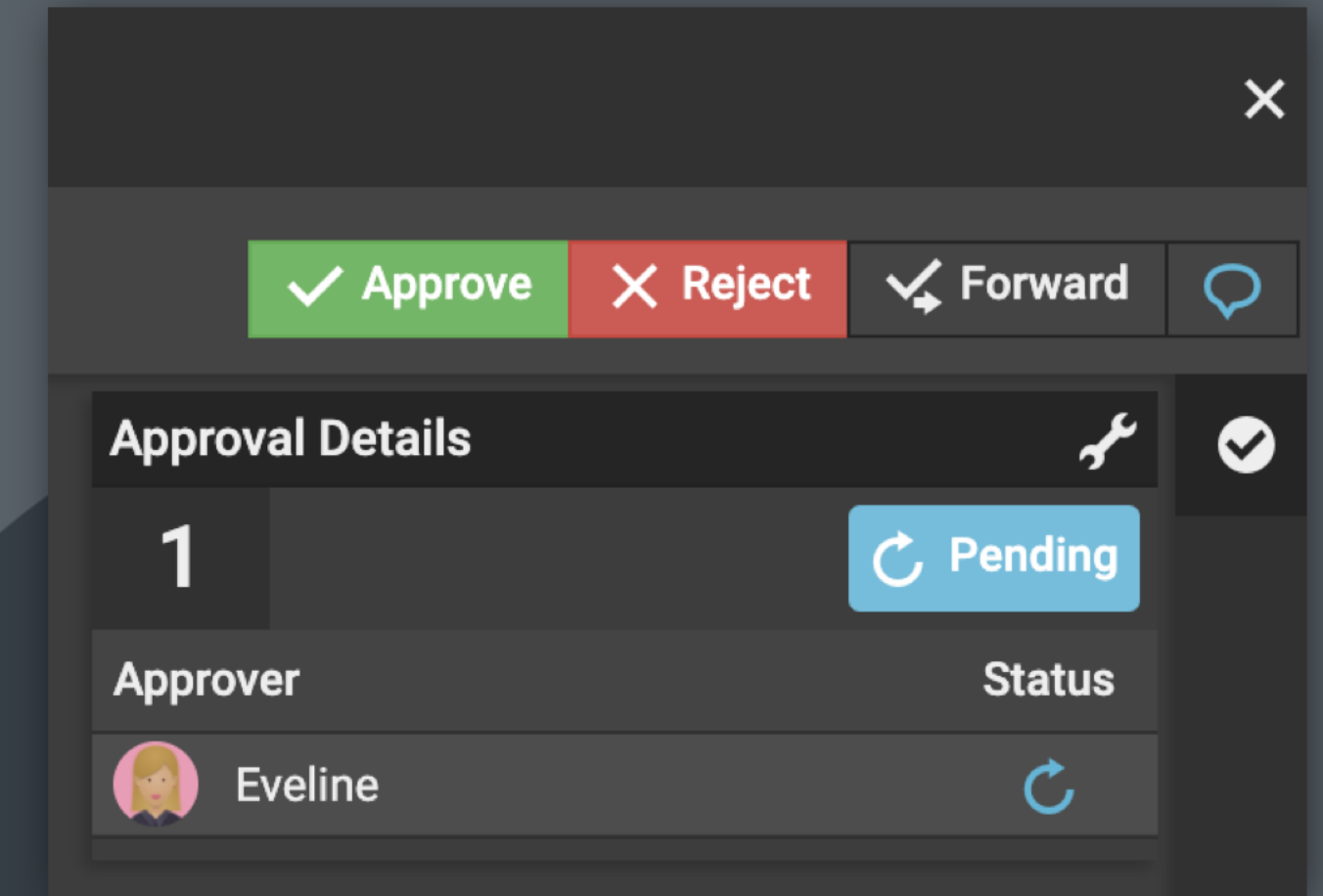

Approval Widget in the Viewer Deep Zoom Mode



Search Text in Microsoft Office Documents



WebCenter SaaS

Unlock the power of New Options available exclusively in WebCenter SaaS

■ (24.03) Variable Data Printing "VDP" Manager Module

■ VDP Manager: Revolutionizing Digital Print Reviews and Approvals

The VDP Manager, a new option for WebCenter, is designed to streamline the review and approval process for promotional variants in digital printing. This innovative module allows users to effortlessly load, view, and approve variant data—ranging from images and text to barcodes—directly within the artwork template. With support for multiple variants per artwork, the VDP Manager ensures that each piece is print-ready, enhancing efficiency and accuracy in digital printing projects.

■ Key Features:

- **Enhanced Viewing Experience:** Utilize the VDP Viewer to seamlessly preview and approve artwork variants in one comprehensive interface.
- **Effortless Data Integration:** Easily upload variant data using CSV formats and interactively update your database within the viewer.
- **Dynamic VDP Preflight Reports:** Generate and view VDP Preflight Reports directly in the widget, identifying and resolving errors and warnings without navigating through the entire document.
- **Comprehensive Variable Data Support:** From placeholder support for PDFs to live previews of updates, manage every aspect of your variable data with precision.

- VDP Manager transforms the way promotional variants are reviewed and approved, offering a robust solution for ensuring the integrity of your digital prints. Whether updating values or detecting potential issues before they impact your project, this module is your key to a streamlined, error-free digital printing process.



Variable Data Printing Management



Configuration Management

Testing and updating WebCenter with specialized tools

- (24.03) Enhanced Named Configuration Migration and Management
 - This update brings critical advancements to the management and migration of Named Configurations, streamlining administrative tasks and ensuring smooth transitions across servers.
 - **Efficient Configuration Handling:** Enhancements in indexing, comparison, and migration processes for project and template configurations simplify the setup and maintenance of Named Configurations.
 - **Document Approval and Reference Migration:** Improved migration processes for document approval setups and reference values, ensuring only relevant references within Named Configurations are carried over, with clear guidance on handling external and outdated references.
 - **Metadata Insights for Better Transfer:** Exported Named Configurations now include detailed metadata, offering insights into the source system and facilitating informed decisions during imports with a comprehensive impact analysis.
 - **Streamlined Impact Analysis and Import Logs:** The import process is refined with a better-organized impact analysis and a separate tab for import logs, enhancing clarity and making it easier to assess and manage changes.
 - Designed for administrators, these improvements aim to optimize the creation, analysis, and migration of Named Configurations, making it easier to replicate and deploy configurations across different server environments.

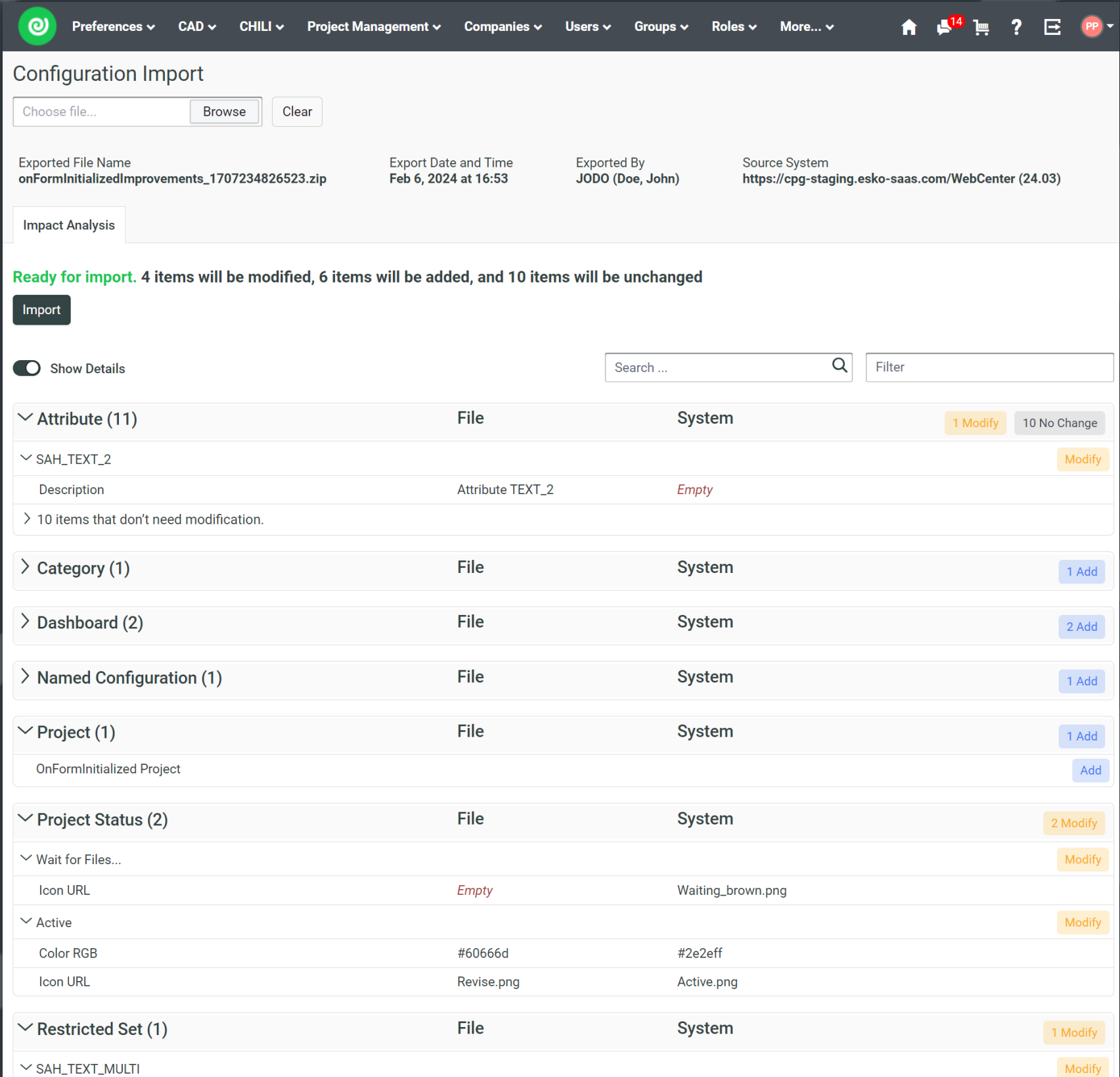

Sample configuration import UI

HISTORY: (23.07) Improved Attribute Labels (23.07) Named Configurations (Import/Export) (23.03) New Feature! Identify and work with Named Configurations (23.03) More Flexible Invite Member Node (23.03) Page Builder Improvements (22.11) Call External API from within the workflow canvas (22.11) Restrict Value of attributes via another attribute (22.11) Bearer token authentication added to external API connections (22.03) Migration Tools Enhancements (22.03) Dashboard Integration Connection (22.03) Visibility Rules Enhancements





Configuration Enhancements

Configure and administer WebCenter easier, faster and with less clicks.

- **(24.03) Automatically Populate Document Reference Forms**
 - Automatically populate document reference forms with the new “OnAdded” Script. This feature allows the addition of an “On Document Added” script to document reference attributes in a dashboard form. The script activates when a document is added, referenced, copied, or uploaded, streamlining the document management process.
- **(24.03) Automatically Populate Project and Task Forms**
 - Enhance form efficiency with the ‘on form initialized’ script to pre-populate your forms. Dashboards now support defining On Form Initialized Scripts, executed upon dashboard form initialization. These scripts, applicable in Project, Document, and Task Dashboards in Edit or Create mode, can modify objects in the current context to streamline form preparation.
- **(24.03) Task Creation from Dashboard**
 - Easily create tasks directly from Dashboards using Buttons, Inline Actions, or Table Actions. If linked to a creation Dashboard, users can fill out a pop-up form with task specifications. Tasks can be started or saved for later with corresponding buttons. For tasks initiated from document dashboards, automatic document attachment is possible, streamlining task setup.
- **(24.03) Customizable Document Viewer Modes**
 - Enhance document viewing with customizable modes. Set documents to open in Standard or Deep Zoom modes, with optional flexibility to switch between them. This update streamlines document interaction, allowing for a more efficient and personalized viewing experience.

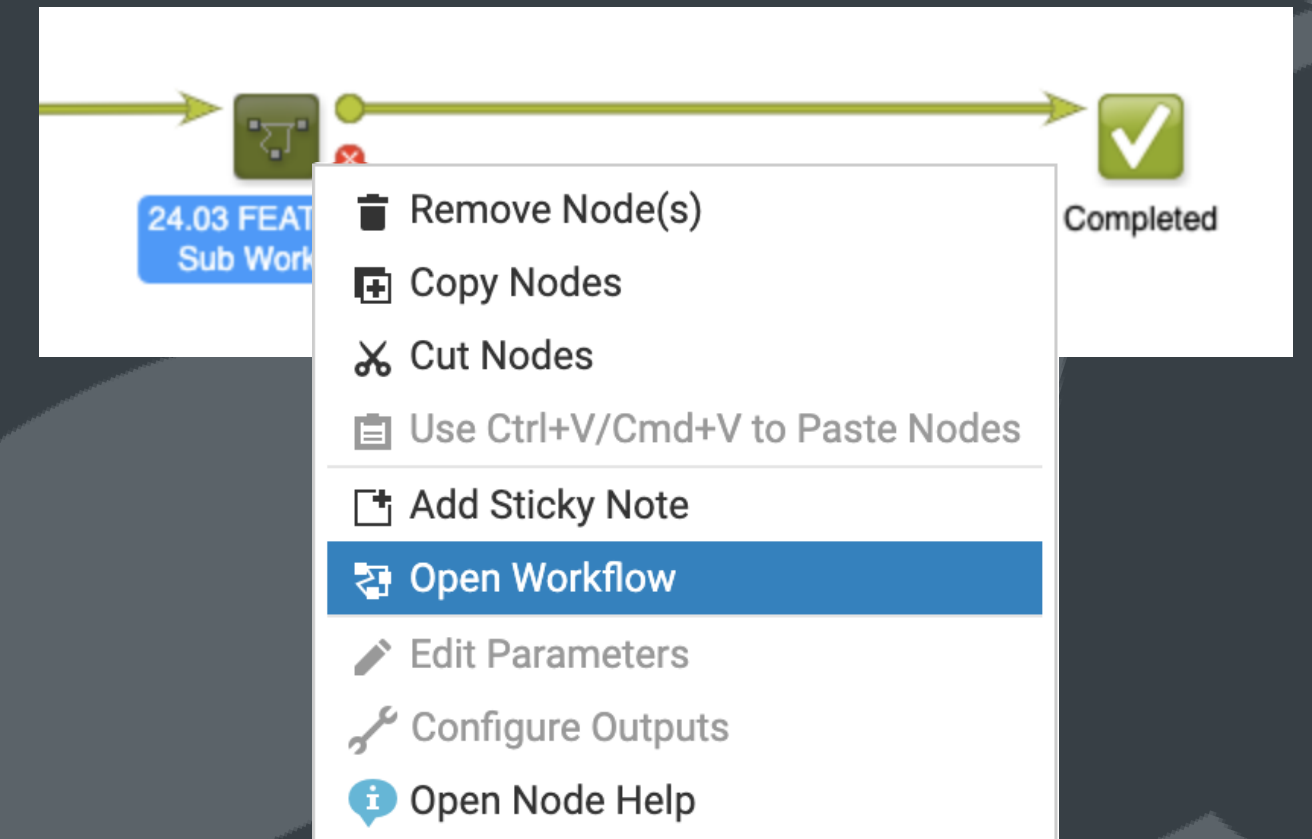

Direct Access to Task Types and Sub-Workflows

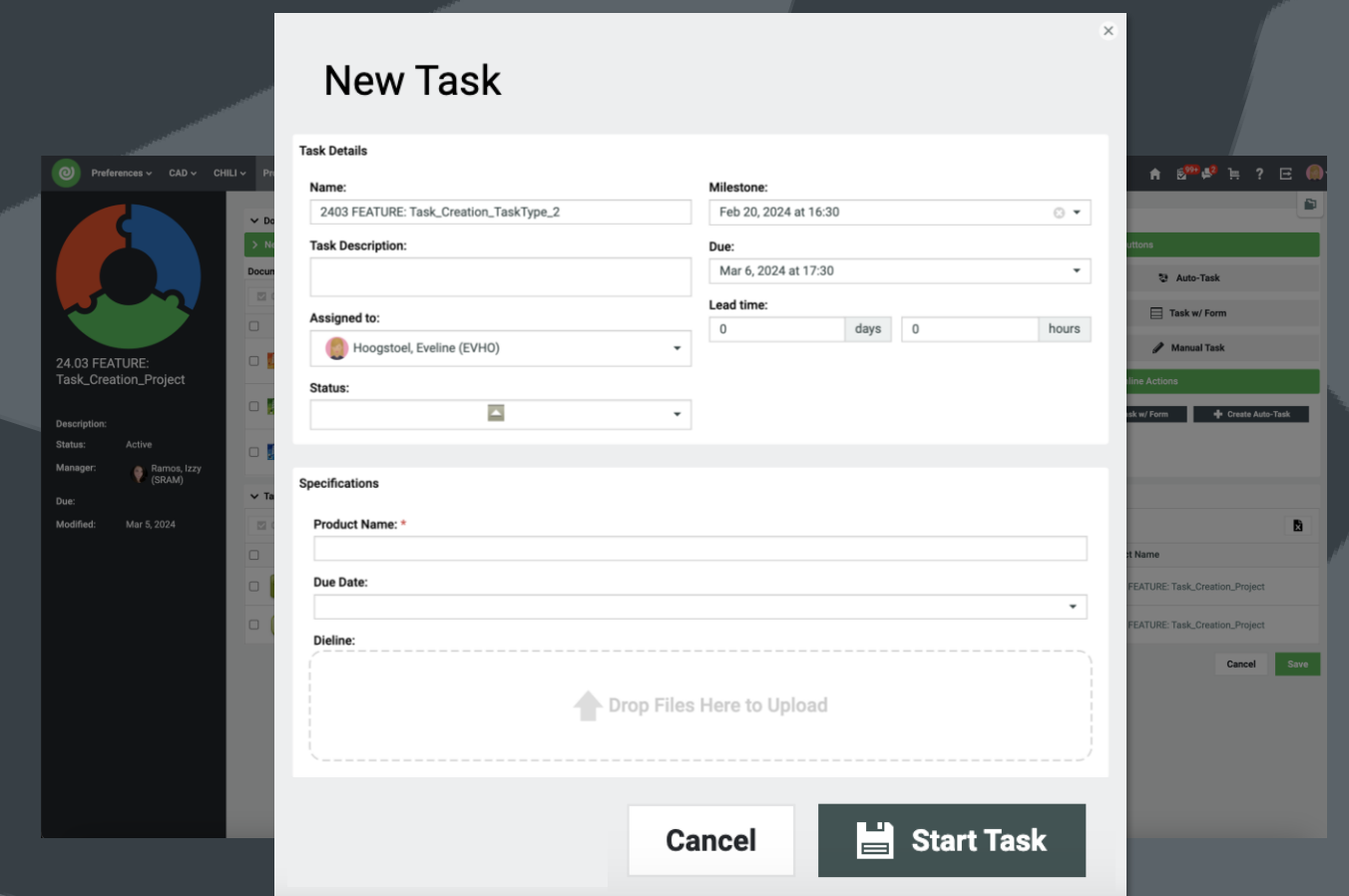

Task Creation from Dashboards

HISTORY: (23.07) Improved Attribute Labels (23.07) Named Configurations (Import/Export) (23.03) New Feature! Identify and work with Named Configurations (23.03) More Flexible Invite Member Node (23.03) Page Builder Improvements (22.11) Call External API from within the workflow canvas (22.11) Restrict Value of attributes via another attribute (22.11) Bearer token authentication added to external API connections (22.03) Migration Tools Enhancements (22.03) Dashboard Integration Connection (22.03) Visibility Rules Enhancements



Scalability & Performance

Work in WebCenter with more teammates on more projects with the best performance possible.

- **(24.03) Faster Discussions for Large Groups**
 - We've significantly improved loading times for discussions with extensive participant lists. By optimizing backend permission checks, discussions now load up to 34 times faster than before, making your experience smoother and more efficient, especially in projects with over 1000 participants.
- **(24.03) Enhanced Content Sheet Render Speed**
 - Content sheets now render up to 84% faster, providing a more responsive and efficient experience when loading content sheets.
- **(24.03) Improved rendering speed of certain 3D scenes**
 - The 3D viewer was updated. The update brings performance related fixes. Models with complex (repeated) geometry will load significantly faster in the viewer.
- **(24.03) Enhanced Security with Veracode CVSS 3 Compliance**
 - WebCenter has achieved a significant security milestone by adhering to Veracode CVSS 3 standards, ensuring a more secure platform for our users. This compliance means we've thoroughly assessed potential vulnerabilities against a comprehensive framework, focusing on factors like attack complexity and user interaction, to provide robust protections against security threats. Our commitment to CVSS 3 standards reflects our dedication to maintaining high security policy compliance, offering peace of mind and a safer environment for all users.

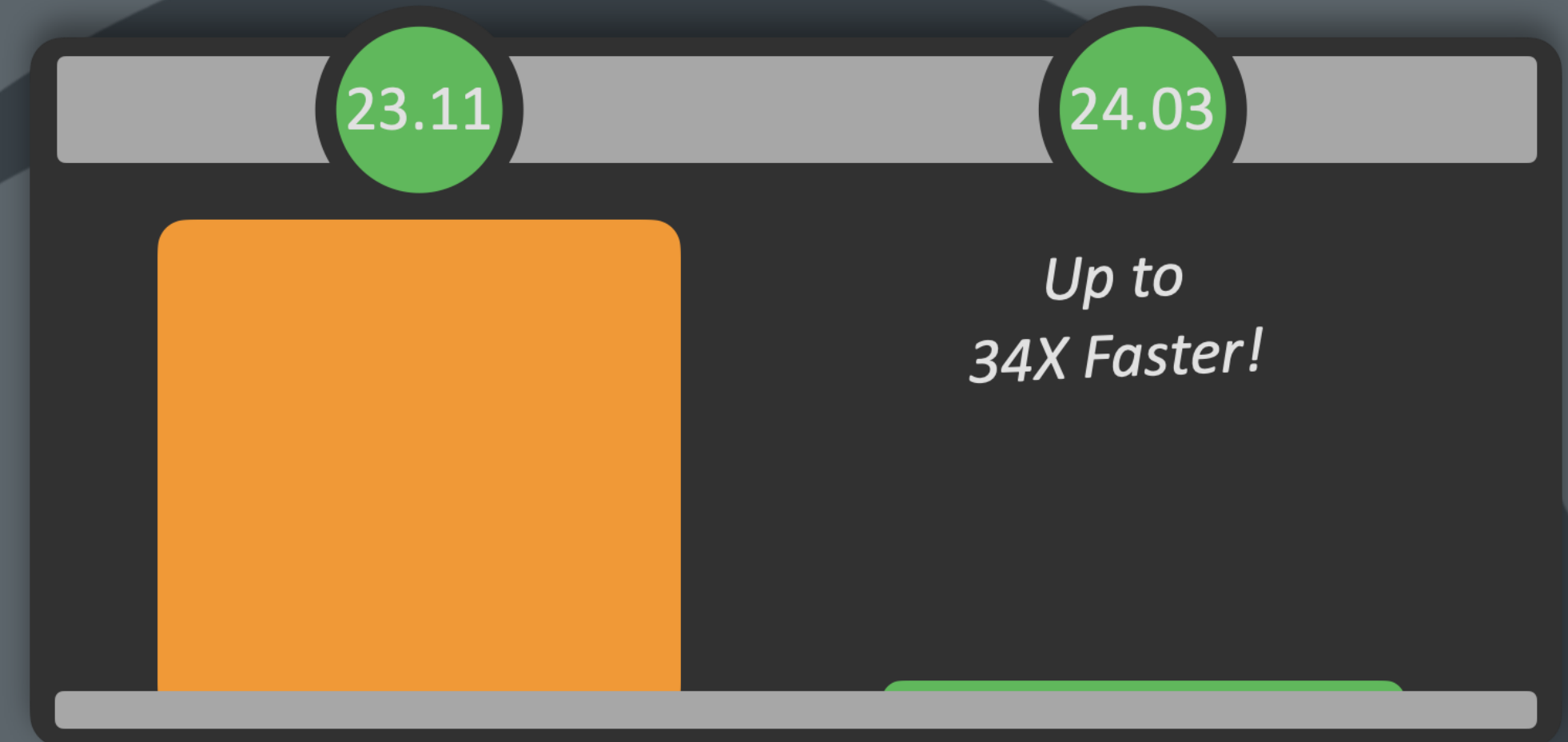

Discussion Load Times 1000+ Participants

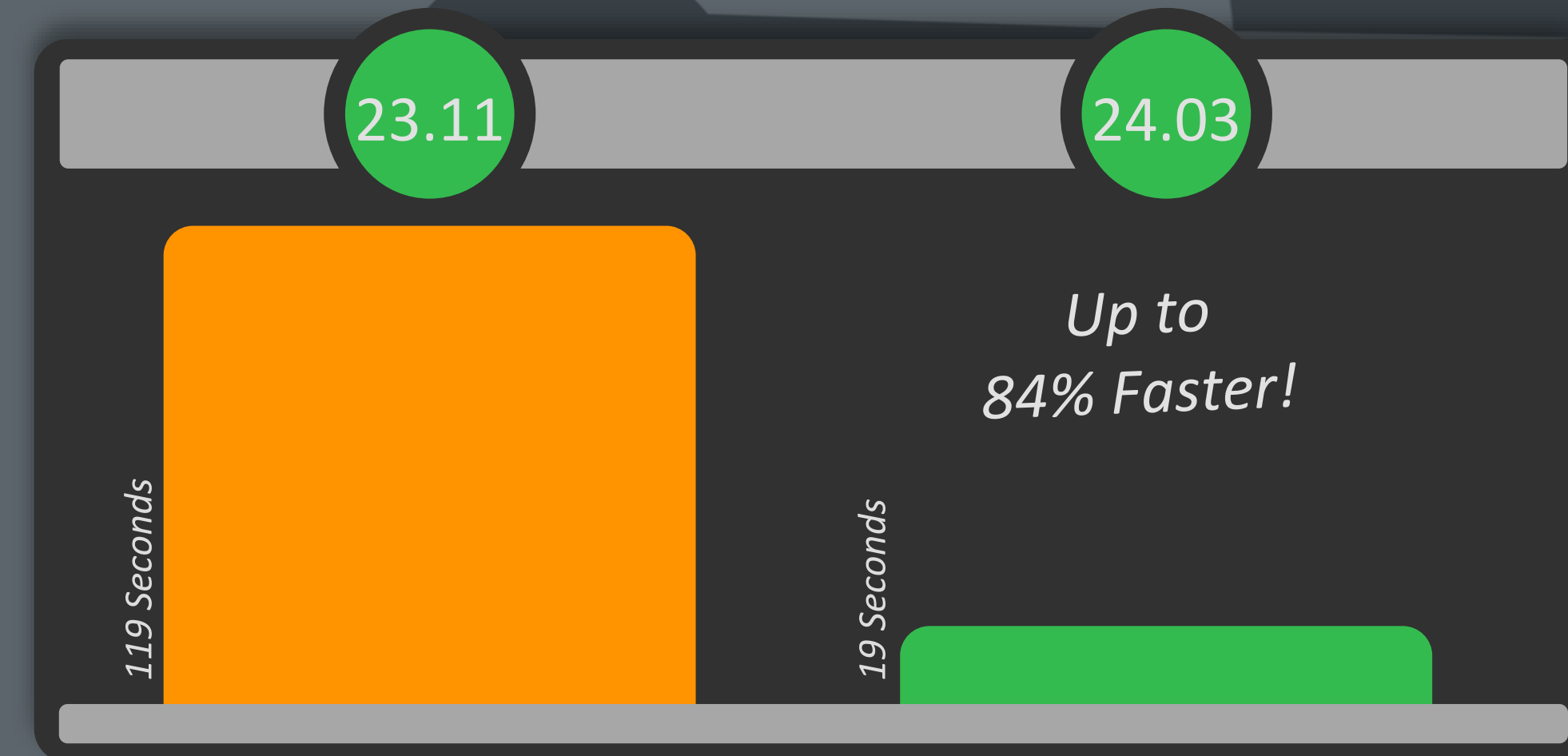

Content Sheet Load Times (625 Widgets)

HISTORY: (23.11) Select Document Node Enhancement (Speed) (23.11) 3D Rendering Enhancements (23.03) Improved Workflow Node Performance (23.03) Other Performance Improvements (22.11) Improved Page Loading Experience (22.11) Increased Performance on bulk content copy (22.07) Search crawler "Fast crawl" mode (22.07) Render optimizations for complex content sheet dashboards (22.07) Improved workflow performance (22.03) Workflow Performance Enhancements (22.03) Cleanup Tool Optimization



Plug-ins for Adobe®

- (24.03) WebCenter Tasks Plug-In: Support for Structured Content Documents
 - *The WebCenter Tasks Plug-In now facilitates importing structured content directly into Adobe InDesign, complementing its capabilities for multi-page artwork like leaflets. This update simplifies artwork adjustments and template testing, integrating seamlessly with WebCenter's automation features for efficient design workflows.*

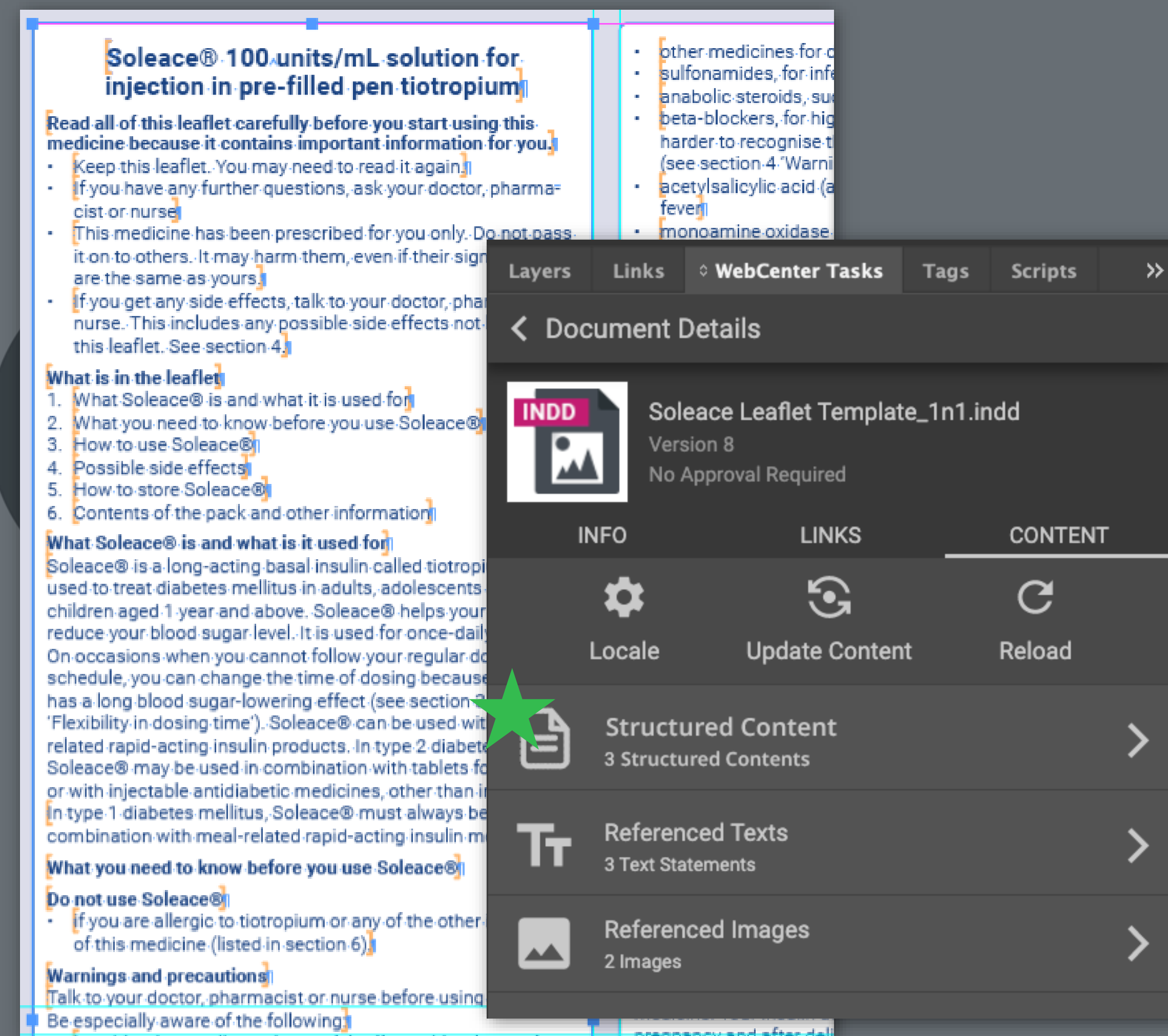

HISTORY: (23.07) Annotation Overlay (23.07) Support for All Annotation Types (23.07) Annotation Author Visibility (22.03) Task Plugin: Improved SSO (SAML) Authentication Support

The Task Plugin is available for download here: <https://www.esko.com/en/support/downloadsandlicenses/free-software>

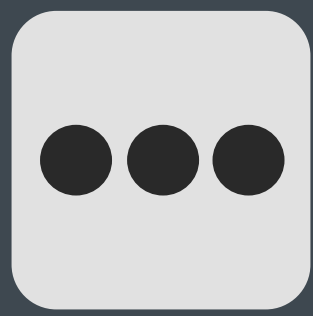

General Enhancements

- **(24.03) Secure Download Link with Verification**
 - Enhance file sharing security with secure download links, a feature that must be enabled by an administrator. This allows for the secure distribution of files to external parties, where recipients are required to enter a verification code received in a separate email before downloading. This added layer of security ensures that sensitive information is protected and accessed only by intended recipients.
- **(24.03) Integration Capability with GlobalVision Verify**
 - WebCenter now supports integration with GlobalVision Verify, enhancing our text comparison suite alongside TVT and InformalT. This new feature is ideal for customers who already use GlobalVision Verify for artwork approval and content inspections, offering an uninterrupted workflow within WebCenter. For integration, customers need to have their own GlobalVision Verify subscription. The necessary integration kit is available for purchase from ESKO, facilitating seamless inspection processes and reporting back to WebCenter.
- **(24.03) Easy Upgrade to Registered Users**
 - Now in WebCenter, easily convert unregistered users (email-based approvers) to registered users directly from the User Management page. The system automatically identifies and suggests upgrades for existing unregistered users, streamlining their transition to full user status while retaining their approval history.

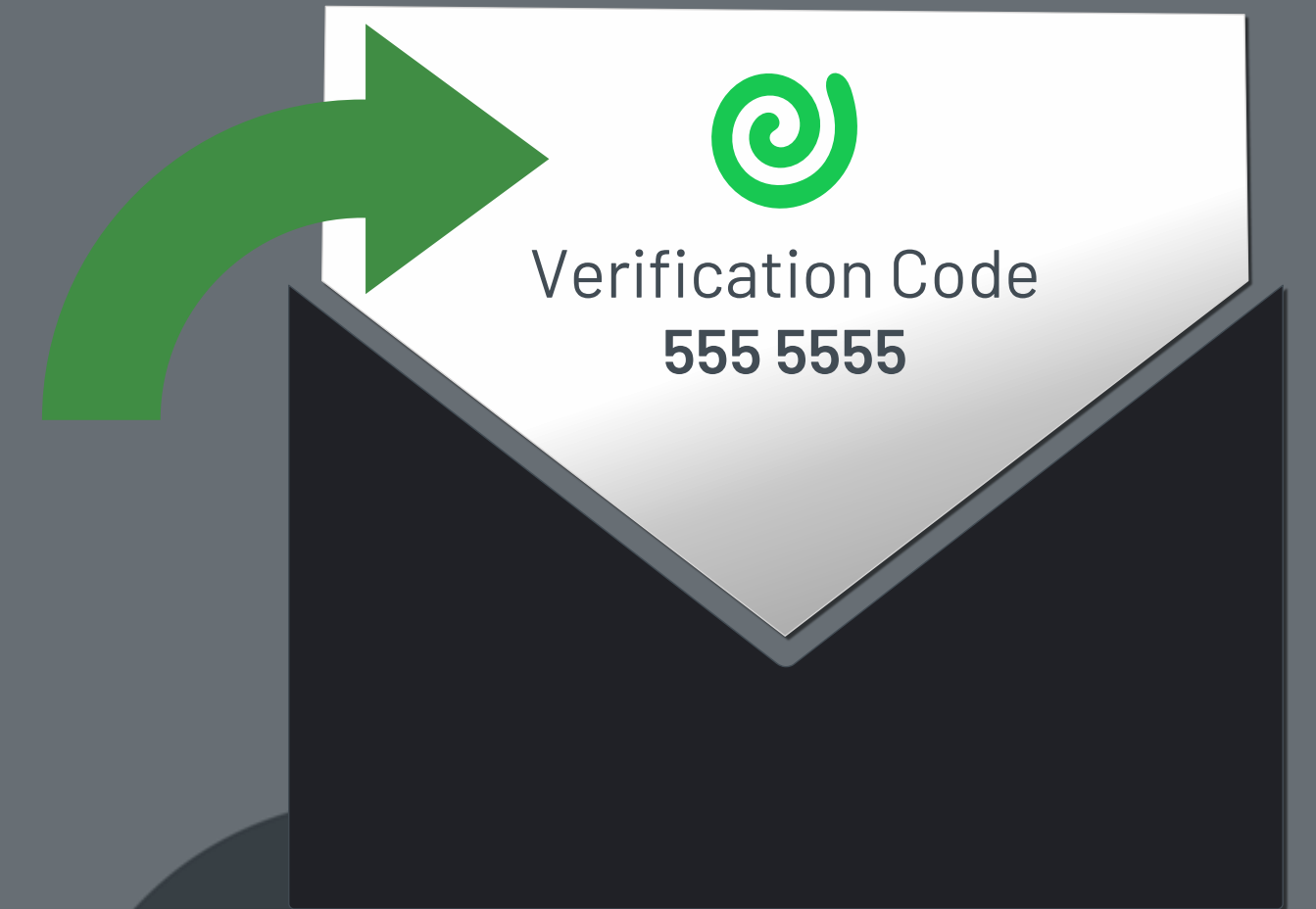

Secure Download Link Verification

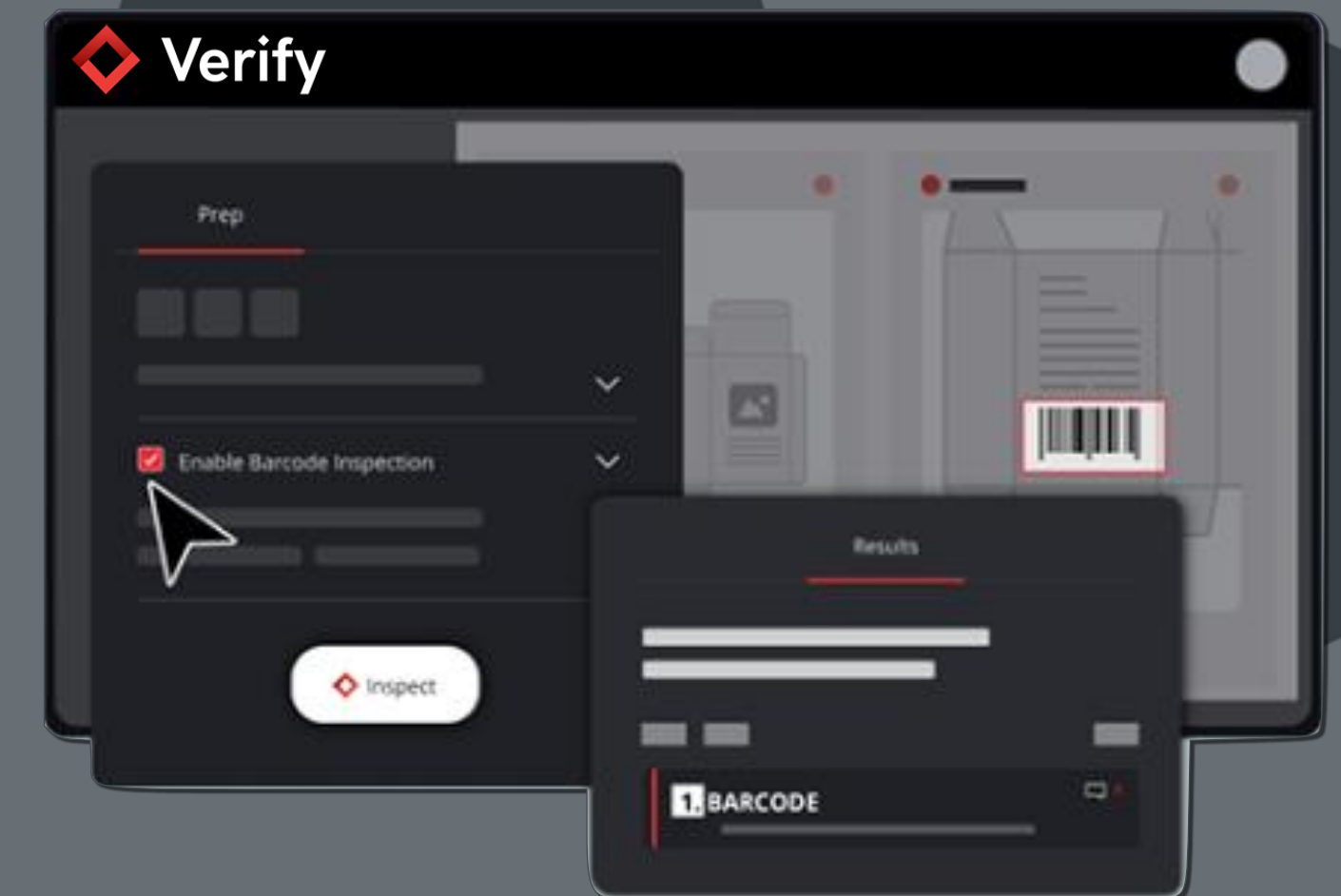

GlobalVision Verify Integration

HISTORY: (23.11) Move Copy Node Enhancement (prevent auto-naming) (23.11) Enhanced User Administration Permissions (23.11) Enhanced Project History Permissions (23.11) Multiple Reference Files for Text Compare (23.11) Flexible Admin Rights SDK (23.11) Save Tasks Progress (23.07) Administrator Group Rights (23.07) Expanded Keyword Search (23.07) Audit Trails: Inclusion of Old Metadata Values (23.03) Saved Search Export can now be canceled. (23.03) New Progress Bar Visible When Saving Forms (23.03) New File Type Conversion Workflow Node* (22.11) Improved List Look-up Feature (22.11) Chili Integration Improvements (22.11) Improved Options for Approving Documents Outside the Viewer (22.07) Updated Oracle Database Support to Version 19C (22.07) Ability to use S3 as a storage location (22.07) WebCenter Web Server Tomcat Update (22.03) Named User License Simplification (22.03) Color: Curve Value Configuration & Auto Load Options



Content Management for Packaging

Produce error free packaging by standardizing the content collection process and to automate the flow of content into artwork.

- **(24.03) Translation Filtering for Text Statements**
 - *Enhance efficiency with translation filtering, allowing you to display only relevant languages. This feature simplifies updates by reducing the need for extensive scrolling through dozens of translations, focusing only on those applicable to your project.*
- **(24.03) Improved Rich text Controls**
 - *Dealing with 25 text statements, each with 25 languages, means that screen real estate needs to be carefully managed. In 24.03, we've moved the formatting tools to be outside the text box being edited, giving you more room to work.*

History: (23.11) Faster Loading of Content Sheets (23.07) Content Sheet Approval, (23.07) Nutrition Facts Handling, (23.03) Export Content Sheets to Excel, (23.03) Global Content Permissions, (22.11) Interface improvements, (22.11) Language context for dashboards, (22.11) Allow text statement version updates in dashboard, (22.11) Improve performance for large content sheets, (22.11) Chili Cloud support, (22.07) Flexible Master Language, (22.07) Improved Dashboard JS API, (22.07) Improved Save (Performance)



Content Management for Life Sciences

Standardizing the process to define and approve document content and automating the flow of content into output templates.

- **(24.03) Fonto Editor Upgrade 8.6: Enhanced Language and Comparison Features**
 - *The latest Fonto Editor upgrade introduces Right-to-Left language support, enabling seamless authoring and reviewing in RTL languages. Additionally, improved table comparison offers precise insights into data changes, moving beyond the 'all or nothing' approach to highlight specific alterations in tables on leaflets. This enhancement ensures critical data points are accurately tracked across versions.*
- **(24.03) Revert a Topic in Structured Content Editor**
 - *Choosing to edit a topic was a reserved action for when you were absolutely sure you were going to make edits. Now you can check out with abandon, as those changes can be reverted back to their library versions with no impact to your structured content document.*
- **(24.03) InDesign Content Previewer**
 - *For managing content, context is critical - where and how a particular content element appeared on the packaging or leaflet artwork which was always only available once artwork was automatically generated. In 24.03, when using InDesign artwork templates, you can now preview how content appears in the Viewer before artwork is generated, making Right-First-Time that much closer.*

History: (23.11) Improved Support for Reference Content Libraries (23.11) InDesign Template Selection Improvements (23.07) Improved Loading for Documents in Editor, (23.07) Show Outdated Content References in Outline, (23.03) Previewing Structured Content, (23.03) Transfer Output Styles automatically to InDesign Leaflets, (23.03) Toggle Whitespace in the Editor, (22.11) Allow copying of artwork tags between maps, (22.11) Include changes from the previous version when preparing submissions, (22.11) Continuing to improve and simplify the user experience, (22.11) Notify editors when source content has been updated, (22.11) Allow users to see source content when editing a translation, (22.11) Support for wider variety of Word output formats, (22.07) Compare Content Maps, (22.07) Granular Tagging (finer control of placement in InDesign), (22.07) Editor (Fonto) Improvements, (23.07) Improved Loading for Documents in Editor, (23.07) Show Outdated Content References in Outline